

LABORATORY FAUCET - DOUBLE

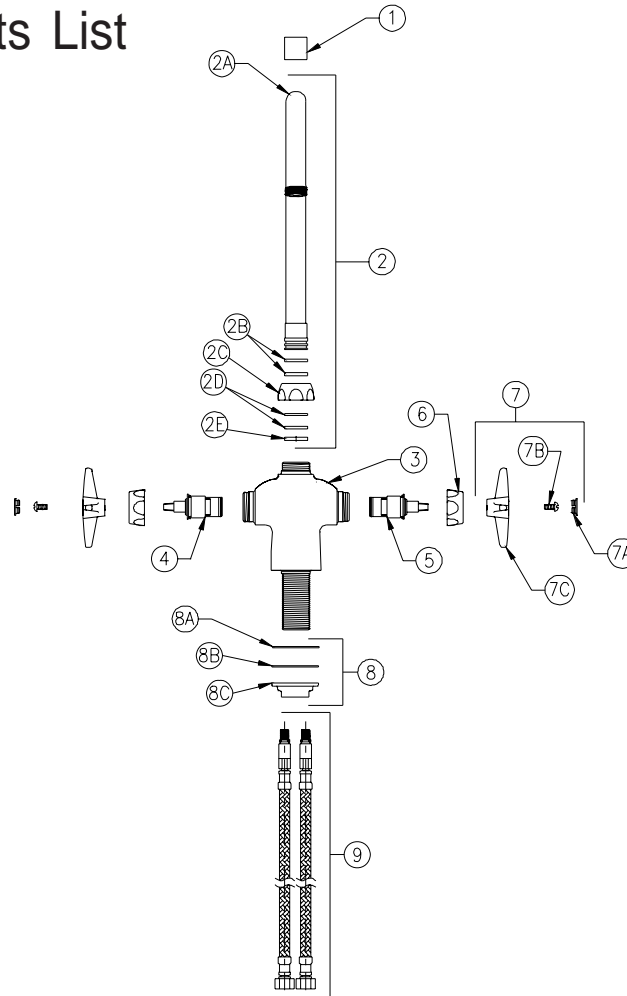

Z826C2-XL Parts List



Item	Part Number	Description	Qty.
1	G63504	3/4"-27 Female Aerator	1
2	G67853	8" [203mm] Centerline Gooseneck Spout Ass'y.	1
2A	92866003	8" Centerline Gooseneck Spout	1
2B	58155018	O-Rings	2
2C	59435001	Spout Nut	1
2D	59666001	Plastic Split Washers (used for swing configuration only)	2
2E	59436001	Spacer Washer (used for rigid configuration only)	1
3	60822003	Double Lab Body	1
4	59517005	Short Cold Cartridge	1
5	59517006	Short Hot Cartridge	1
6	59523001	Handle Nut	2
7	G60503	Vandal-Resistant Four Arm Handles	1
7A	G60500	Hot/Cold Color-Coded Indexes	1
	59454001	Hot Color-Coded Index	1
	59454002	Cold Color-Coded Index	1
7B	62464001	10-32 Screw	2
7C	59518001	Four Arm Handle	2
8	G61073	Mounting Hardware	1
8A	60549002	Friction Gasket	1
8B	60444002	Washer	1
8C	60445002	Mounting Nut	1
9	93318012	12" [305mm] S.S. Braided Flex Hoses	2

ZURN INDUSTRIES, LLC ♦ COMMERCIAL BRASS OPERATION ♦ 2640 SOUTH WORK STREET ♦ FALCONER NY 14733

Phone: 1-800-997-3876 ♦ Fax: 1-919-775-3541 ♦ www.zurn.com

In Canada: ZURN INDUSTRIES LIMITED ♦ 3544 Nashua Drive ♦ Mississauga, Ontario L4V1L2 ♦ Phone: 905/405-8272 Fax: 905/405-1292